



earthtestenergy

bridge mills, huddersfield road, holmfirth, hd9 3tw

tel 01484 681 314

fax 01484 689 932

e-mail [info@earthtestenergy.com](mailto:info@earthtestenergy.com)

web [www.earthtestenergy.com](http://www.earthtestenergy.com)





# An environmentally conscientious customer





## Part renovation, part new build







# Five offices totalling 825 m<sup>2</sup>

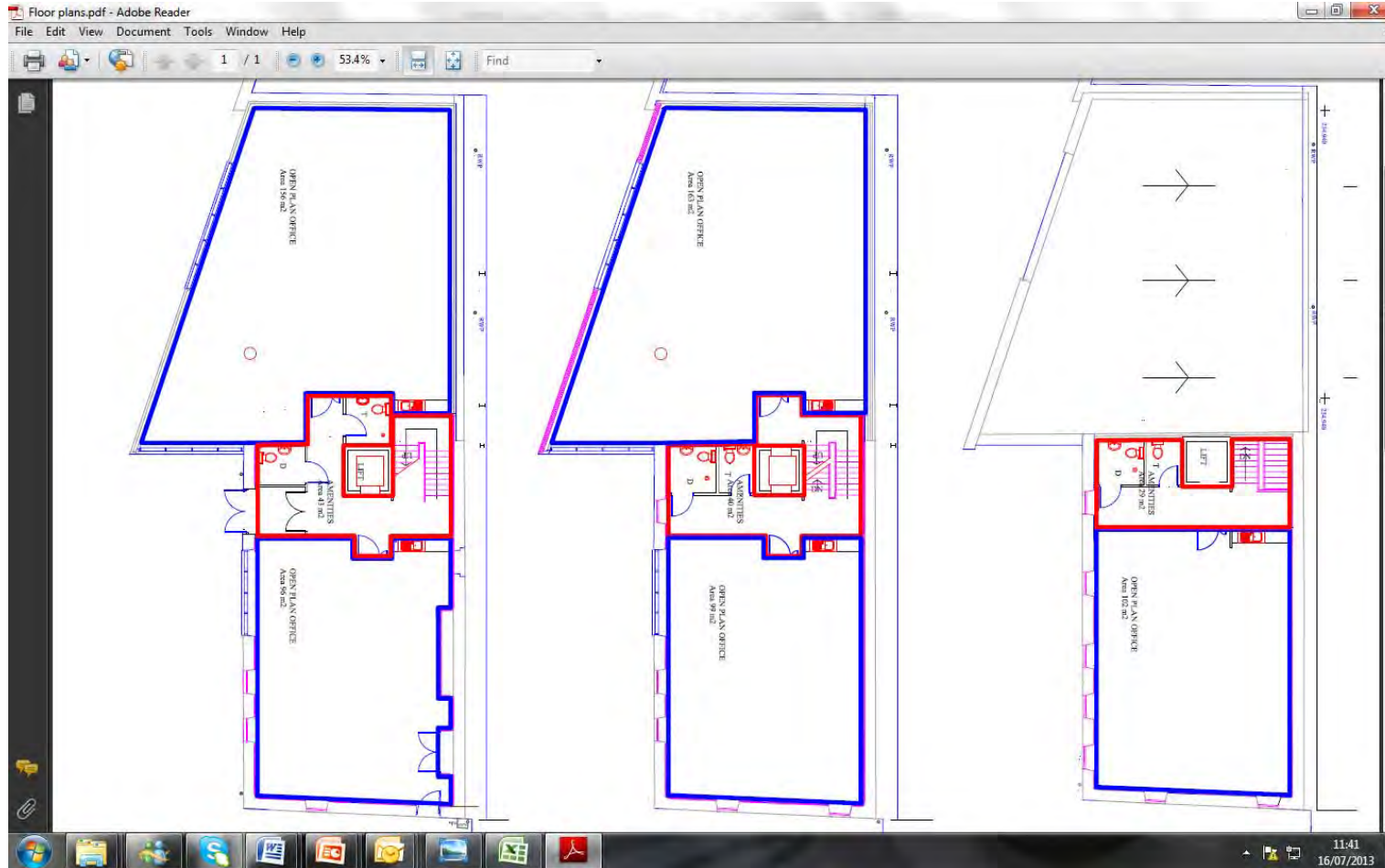



# Mechanical Ventilation with Heat Recovery







# Open loop system uses natural ground water







# Underfloor Heating





# ground source heat pump







# An Energy Performance Certificate to die for?





# Heat meter installation





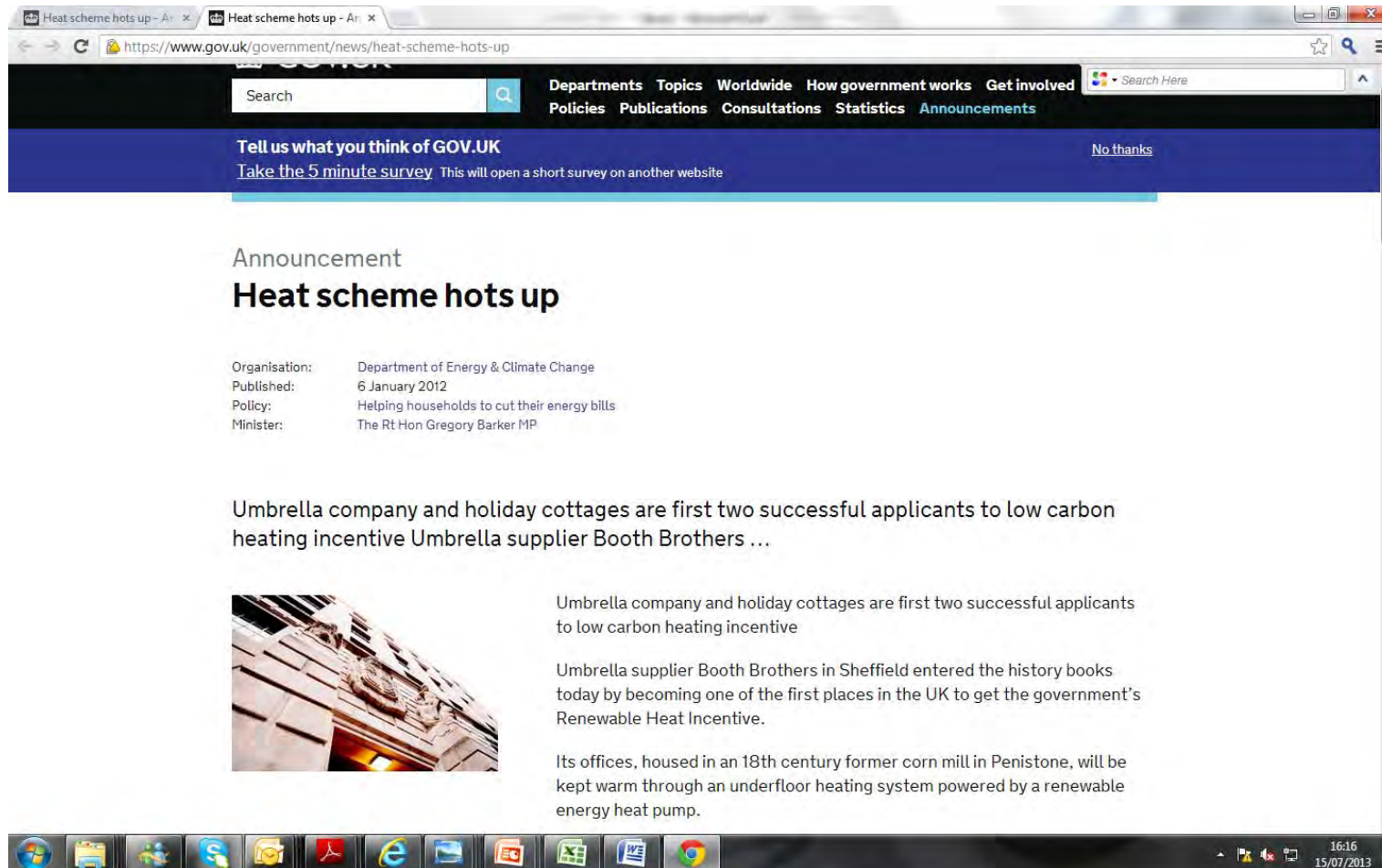

# First ever RHI approval

A screenshot of a web browser displaying a government announcement. The browser's address bar shows the URL "https://www.gov.uk/government/news/heat-scheme-hots-up". The page has a dark blue header with a search bar and navigation links. Below the header is a blue banner with the text "Tell us what you think of GOV.UK" and a link to "Take the 5 minute survey". The main content area is white and features the heading "Announcement Heat scheme hots up". Below this is a table with details about the announcement, including the organization (Department of Energy & Climate Change), publication date (6 January 2012), policy (Helping households to cut their energy bills), and minister (The Rt Hon Gregory Barker MP). The main text of the announcement states that "Umbrella company and holiday cottages are first two successful applicants to low carbon heating incentive" and "Umbrella supplier Booth Brothers ...". A photograph of a building is shown on the left, and text on the right explains that the building's offices will be kept warm through a renewable energy heat pump system.

Heat scheme hots up - Ar x Heat scheme hots up - Ar x

https://www.gov.uk/government/news/heat-scheme-hots-up

Search Departments Topics Worldwide How government works Get involved  
Policies Publications Consultations Statistics Announcements

Tell us what you think of GOV.UK No thanks  
Take the 5 minute survey This will open a short survey on another website

Announcement  
**Heat scheme hots up**

Organisation: Department of Energy & Climate Change  
Published: 6 January 2012  
Policy: Helping households to cut their energy bills  
Minister: The Rt Hon Gregory Barker MP

Umbrella company and holiday cottages are first two successful applicants to low carbon heating incentive Umbrella supplier Booth Brothers ...



Umbrella company and holiday cottages are first two successful applicants to low carbon heating incentive

Umbrella supplier Booth Brothers in Sheffield entered the history books today by becoming one of the first places in the UK to get the government's Renewable Heat Incentive.

Its offices, housed in an 18th century former corn mill in Penistone, will be kept warm through an underfloor heating system powered by a renewable energy heat pump.

16:16  
15/07/2013



# Non Domestic RHI payments

**26kw heat pump first year's RHI payments £2,800**

**Which equates to 2,400hrs (27% capacity)**

**If offices had only been constructed to Building Regulations standards,  
it would have saved:**

Delete extra insulation	Save	£15,000
Delete triple glazing	Save	£8,000
Delete airlock doors	Save	£7,000
Allow increased permeability	Save	£3,000
Carpets instead of ceramic tiles	Save	£10,000
Delete Ventilation heat recovery	Save	£35,000
Add extra heatpump	Add	£11,000
	<b>Saving:</b>	<b>£67,000</b>

**52kw heat pumps revised RHI payments £5,600**

Additional RHI payments more than pay for the extra heatpump and the extra electricity costs





# Domestic properties



Listed building no wall insulation single glazed windows.

26kw heat pump

Fully insulated, double glazed, tiled floors, mechanical ventilation with heat recovery.

12kw heat pump





# Domestic RHI payments

**12kw heat pump COP 4.6, SPF 4.3**

**RHI payments**

**$18.8p \times (1 - 1/4.3) \times 12kw \times 2,400hrs = \text{£}4,155 \text{ per year}$**

**26kw heat pump COP 3.7, SPF 3.4**

**RHI payments**

**$18.8p \times (1 - 1/3.4) \times 26kw \times 2,400hrs = \text{£}8,300 \text{ per year}$**

Additional RHI payment pays for the larger heat pump and the extra electricity costs and delivers a handsome profit





earthtestenergy

bridge mills, huddersfield road, holmfirth, hd9 3tw

tel 01484 681 314

fax 01484 689 932

e-mail [info@earthtestenergy.com](mailto:info@earthtestenergy.com)

web [www.earthtestenergy.com](http://www.earthtestenergy.com)